

VIGO Q

SPECIFICATIONS

| | | |
|--------------------|---------|----------------------|
| MOUNTING | | WALL |
| POWER | [W] | 4 |
| LAMP | | built-in LED |
| LUMINOUS FLUX* | [lm] | 485 |
| LIGHT COLOUR | [K] | 3000 |
| CRI | | >80 |
| BEAM ANGLE | [°] | - |
| AVERAGE LIFETIME | [h] | L80/B50.000 |
| LUMINOUS EFFICACY | [lm/W] | 121 |
| POWER SUPPLY | [V] [A] | 220-240V AC 50/60 Hz |
| LED-DRIVER | | INCLUDED |
| DIMMING | | NO |
| THROUGH-WIRING | | YES |
| MATERIAL | | ALUMINUM |
| INGRESS PROTECTION | | IP54 |
| PROTECTION CLASS | | I |
| NET WEIGHT | [kg] | 0,43 |
| GROSS WEIGHT | [kg] | 0,45 |
| COLOUR (HOUSING) | | WHITE ~RAL9003 |
| COLOUR (HOUSING) | | BLACK ~RAL9005 |



LIGHT DISTRIBUTION

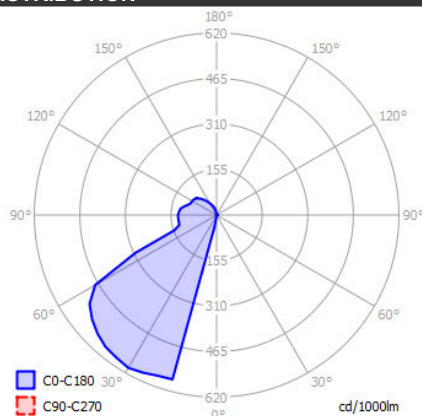

*Luminous flux values are nominal LED data at a operating temperature of 25° C

OPTIONS / OPTIONAL ACCESSORIES

Colours

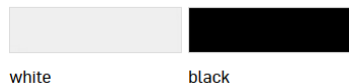

MOUNTING DIMENSIONS

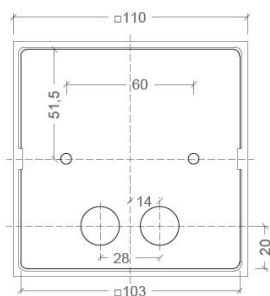

FIXTURE DIMENSIONS

